

## ANSI B16.5 BS10 BS4504

### ANSI B16.5, BS10 & BS4504

Our vast range of flanges allow for the fastening to a pipe to form a rim at the end that can either be covered, closed or allow for the bolting to another length of pipe.

We stock ANSI, BS10 and BS4504 flanges where ANSI and BS4504 flanges are designated a number that relates to the class of the pipe flange and the BS10 standard specifies the requirements needed for the manufacture of the pipe fitting.

Our flanges are also manufactured with different faces. Whilst they are typically flat, they can also be styled as raised tongue and groove or ring joint.

We supply the following various types of flanges:

#### Blind Flanges

A flange with no bore used in applications to close the end of pipe systems.

#### Weld Neck Flanges

A flange that is drilled to the point where the wall thickness is machined to match the dimensions of the pipe. These flanges can be used for high pressure, hot and cold applications.

#### Slip-On Flanges

A flange that is bored to a slightly larger size than the pipe's diameter allowing for the pipe to be slipped into the flange and welded.

#### Screwed Flanges

A flange that is easily attached to a threaded pipe without welding. These flanges are ideal for high pressure and temperature applications for small pipe.

All our screwed flanges come in either black or galvanised finish and our slip on weld flanges come in self colour finish and both are covered in a preservative for the temporary prevention of rust.



#### Plate Slip-On Flange

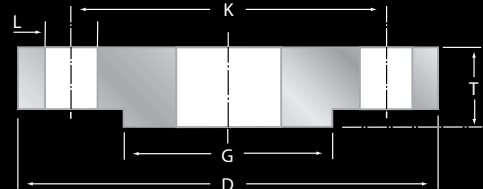

#### Blind Flange

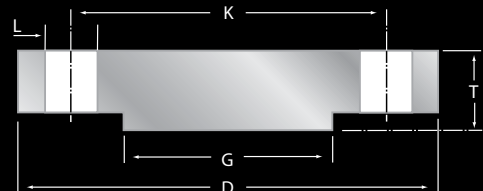

#### Weld Neck Flange

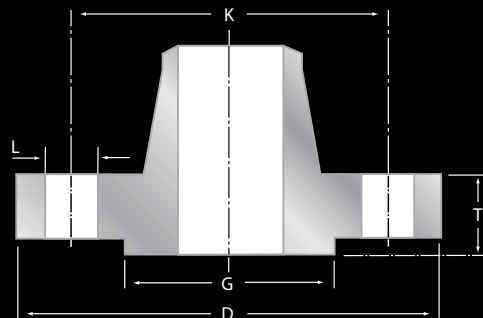

#### Bossed Slip-On Flange

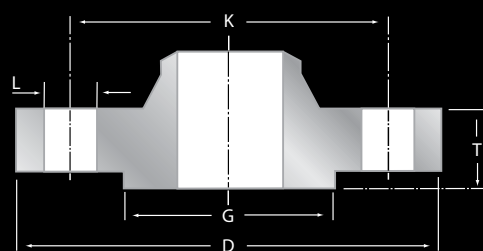

#### Bossed Threaded Flange

